

## Power divider mounting clamps

For ZCG's range of single or two-stage power dividers



In-stock  
Ready to  
Ship  
\* Signifies build to order item

The PDC-S and PDC-L are mast mounting clamps specifically designed for mounting the entire range of ZCG power dividers safely and securely without damaging the power divider.

These clamps can also be used for other purposes - [consult ZCG](#)

Power dividers, coaxial cable, water-proofing and other installation accessories are all available separately.

SKU	PDC-S	PDC-S-120*	PDC-L	PDC-XL*	PDC-XXL*
Construction	All 304 stainless steel clamp plates with stainless steel U-bolts/bolts, flat and spring washers and nyloc securing nuts				
Power divider diameter	25mm - round		40mm - round		
Power divider capability	Consult ZCG for suitable power dividers in single or two stage.				
Mast diameter	30-52mm - round	100-120mm - round	30-52mm - round	40-70mm - round	100-120mm - round
Mounting orientation	Parallel 180° with offset				
Weight	700grams	850grams	760grams	1.0kg	1.2kg
Installation tools required	13mm spanner				

2 clamps recommended for adequate securing of power divider/splitter - mount top and bottom

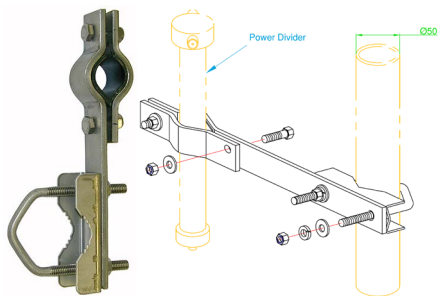

SKU: PDC-S

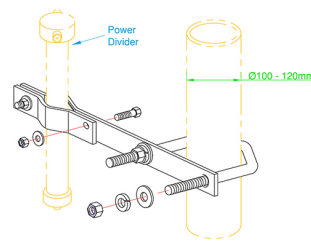

SKU: PDC-S-120

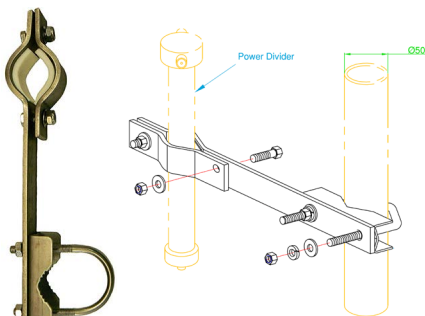

SKU: PDC-L

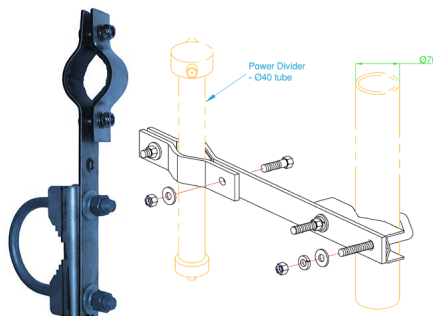

SKU: PDC-XL

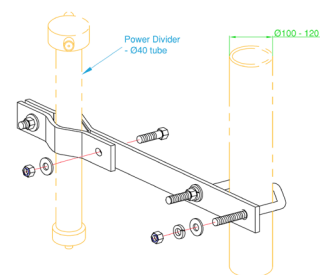

SKU: PDC-XXL

## Power divider mounting clamps

For ZCG's range of single or two-stage power dividers

 **In-stock  
Ready to  
Ship**  
\* Signifies build to  
order item

### PDC-L50\*

Construction	304 stainless steel
Power divider diameter	Up to 40mm - round
Power divider capability	<u>Consult ZCG for suitable power dividers in single or two stage.</u>
Mast diameter	30-52mm - round
Mounting orientation	Parallel 180° - dual
Weight	760grams
Installation tools required	13mm spanner

1 or 2 clamps recommended depending on length



### PDC-L120\*

Construction	304 stainless steel
Power divider diameter	Up to 40mm - round
Power divider capability	<u>Consult ZCG for suitable power dividers in single or two stage.</u>
Mast diameter	70-120mm - round
Mounting orientation	Parallel 180° - dual
Weight	1.6kg
Installation tools required	13mm spanner

1 or 2 clamps recommended depending on length

