

Inter series adaptors

7/8" EIA, 1-5/8" EIA, 3-1/8" EIA & 6-1/8" EIA

Page 1 of 5

In-stock
Ready to
Ship
* Signifies build to
order item

Inter series EIA adaptors are constructed from high quality brass and teflon components providing high level performance and reliability.

The adaptors can be used for field testing applications or permanent interconnection between equipment.

All of these adaptors are built to order.

Combination Kits can be assembled to suit your requirements.

Key features:

- High Quality Components
- Frequency Range : 40 MHz – 1 GHz
- Characteristic Impedance : 50 Ohm
- Rugged Construction

Applications:

- Broadcast Measurements
- Cellular Measurements
- Test and Measurement
- Permanent Interconnection

Performance:

- Low Thru-Loss : 0.01 dB
- Return Loss : < -26 dB over band
- VSWR : < 0.043:1
- Impedance : 50 Ω ± 2.0 Ω

Typical Response

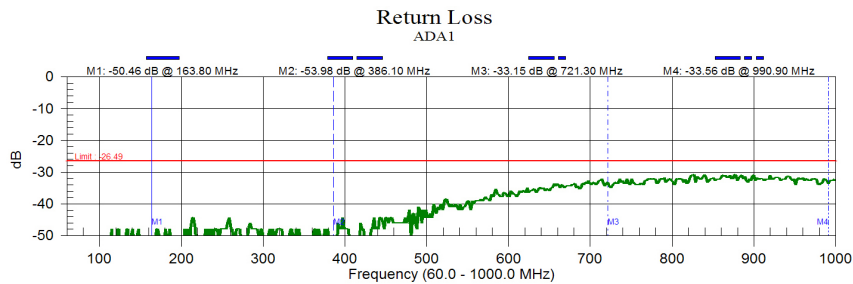

Resolution: 517
Date: Oct/16/2007

CAL:ON(COAX)
Time: 17:20:06

CW: OFF

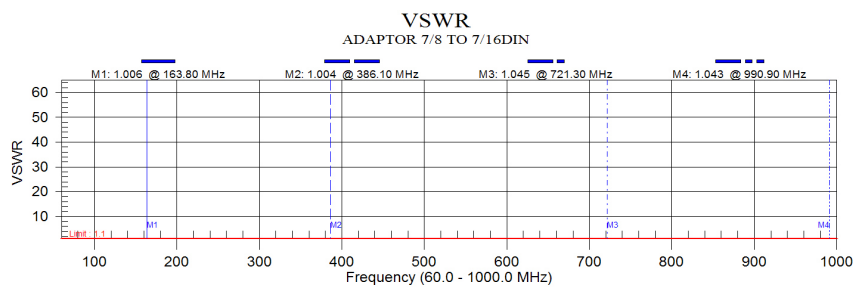

Resolution: 517
Date: Oct/16/2007

CAL:ON(COAX)
Time: 17:20:06

CW: OFF

Smith Chart
ADA1

M1: r=1.00, x=0.00 @ 163.80 MHz
M4: r=0.96, x=-0.01 @ 990.90 MHz

M2: r=1.00, x=0.00 @ 386.10 MHz

M3: r=1.00, x=-0.04 @ 721.30 MHz

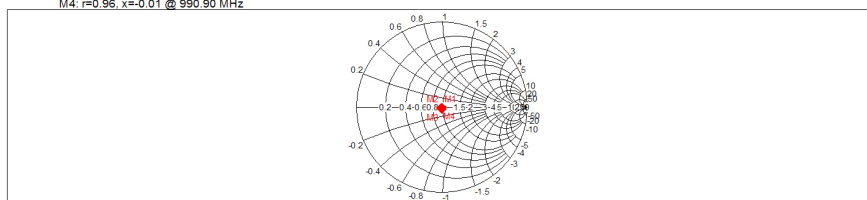

Resolution: 517
Date: Oct/16/2007

CAL:ON(COAX)
Time: 17:20:06

CW OFF
Prop.Vel.: 800

Inter series adaptors

7/8" EIA, 1-5/8" EIA, 3-1/8" EIA, 6-1/8" EIA & Rigid Line

Page 2 of 5

EIA78F-NJ*

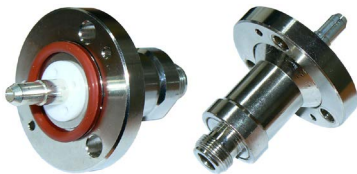

7/8" EIA flanged to N-type female adaptor, incl. bullet, O-ring, & bolts, 500 Watts

EIA78F-NP



7/8" EIA flanged to N-type male adaptor, includes 7/8" EIA joining bullet, 500 Watts

EIA78F-716F-SC



7/8" EIA flanged to 7/16" DIN female adaptor, includes 7/8" EIA joining bullet, 2kW

EIA78F-716M-SC



7/8" EIA flanged to 7/16" DIN male adaptor, includes 7/8" EIA joining bullet, 2kW

EIA78F716MRA*

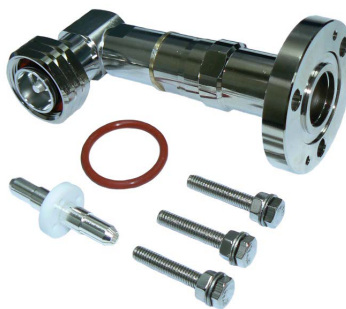

7/8" EIA flanged to 7/16" DIN male right-angle adaptor, includes 7/8" EIA joining bullet, 2kW

EIA78 Rigid Line Flange*



Nickel plated 7/8" EIA rigid line flange adaptor incl. 7/8" bullet, worm drive clamp, O-ring and securing bolts

EIA78 BULLET



Bullet kit for 7/8" EIA connector, includes o-ring and 3 x nuts, bolts & washers

EIA78 Rigid Line Coupler



7/8" EIA slip coupling for rigid line - includes worm drive clamps

EIA78-90EL



7/8" EIA slip coupling for rigid line - includes worm drive clamps

Inter series adaptors

7/8" EIA, 1-5/8" EIA, 3-1/8" EIA, 6-1/8" EIA & Rigid Line

Page 3 of 5



**In-stock
Ready to
Ship**

* Signifies build to order item

EIA158F-NJ



1-5/8" EIA flanged to
N-type female adaptor
500 Watts

EIA158U-NJ*



1-5/8" EIA unflanged to
N-type female adaptor
500 Watts

EIA158U-78F*



1-5/8" EIA un-flanged to
7/8" EIA flanged adaptor
5kW

EIA158F-78FCPL*

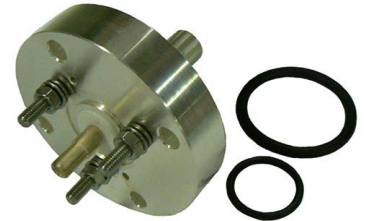

1-5/8" EIA flanged to
7/8" EIA flanged adaptor
5kW

EIA158U-158F



1-5/8" EIA un-flanged to
1-5/8" EIA flanged adaptor
5kW

EIA158-90EL



1-5/8" EIA unflanged to
1-5/8" EIA unflanged elbow
adaptor - nickel plated

EIA158F-90EL

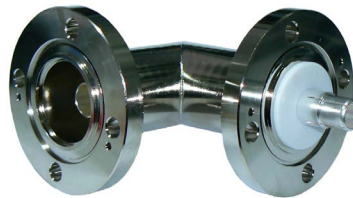

1-5/8" EIA flanged to
1-5/8" EIA flanged elbow adaptor
- nickel plated

A-8322



1-5/8" EIA slip coupling for rigid
line - includes 1 x 27/51 worm
drive clamp

EIA158 Rigid Line Flange*



Nickel plated 1-5/8" EIA rigid line
flange adaptor
incl. 1-5/8" bullet and worm drive clamp

EIA158 BULLET KIT



Bullet kit for 1-5/8" EIA connector,
includes o-ring and
3 x nuts, bolts & washers

A-3389-3*



Joining bullet for
1-5/8" EIA un-flanged connector

Inter series adaptors

7/8" EIA, 1-5/8" EIA, 3-1/8" EIA & 6-1/8" EIA terminated

Page 4 of 5

**In-stock
Ready to
Ship**
* Signifies build to
order item

<p>EIA318F-NJ*</p> <p></p> <p>3-1/8" EIA flanged to N-type female adaptor 500W</p>	<p>EIA318U-NJ*</p> <p></p> <p>3-1/8" EIA flanged to N-type female adaptor 500W</p>	<p>EIA318U-78F*</p> <p></p> <p>3-1/8" EIA unflanged to 7/8" EIA flanged adaptor 5kW</p>	<p>EIA158F-318U*</p> <p></p> <p>1-5/8" EIA flanged to 3-1/8" EIA unflanged adaptor 10kW</p>
<p>EIA158U-318U*</p> <p></p> <p>1-5/8" EIA unflanged to 3-1/8" EIA unflanged adaptor</p>	<p>EIA158U-318F*</p> <p></p> <p>1-5/8" EIA unflanged to 3-1/8" EIA flanged adaptor</p>	<p>EIA158F-318F*</p> <p>1-5/8" EIA flanged to 3-1/8" EIA flanged straight adaptor incl. bolts/O-rings</p>	<p>EIA318-90EL</p> <p>3-1/8" EIA unflanged to 3-1/8" EIA unflanged right-angle adaptor, includes 3-1/8" bullet</p>
<p>EIA318 BULLET</p> <p>Joining bullet <u>only</u> for 3-1/8" EIA connector</p>	<p>EIA318 LINE BULLET</p> <p></p> <p>Joining bullet <u>only</u> for 3-1/8" EIA unflanged connector/adaptor or rigid line</p>	<p>EIA318 Rigid Line Coupler</p> <p>Slip coupler for 3-1/8" EIA rigid transmission line</p>	

Inter series adaptors

7/8" EIA, 1-5/8" EIA, 3-1/8" EIA, 6-1/8" EIA & Rigid Line

Page 5 of 5

In-stock
Ready to
Ship
* Signifies build to
order item

EIA418U-318U



4-1/2" EIA unflanged to
3-1/8" EIA unflanged adaptor,
includes 4-1/2" & 3-1/8" bullets

EIA618F-NJ



6-1/8" EIA flanged to
N-type female adaptor, includes
6-1/8" EIA Bullet, 500 Watts

EIA618U-NJ



6-1/8" EIA unflanged to
N-type female adaptor, includes
6-1/8" EIA Bullet, 500 Watts

EIA618 BULLET*



Joining bullet
6-1/8" flanged
connectors or adaptors